

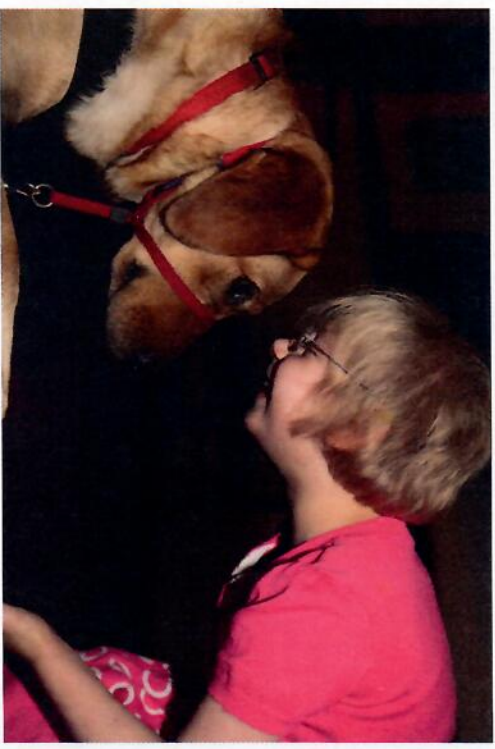

## Canines for Disabled Kids



Created by:

Allen-Michael Jones & Craig Pullen

University of Maine, Presque Isle 2014

© Canines for Disabled Kids

Activity Booklet

Grades 6—8

D A T K G O X H N R I V Z T  
 T I H G N A S E L R V I C E  
 D I I G N A S E L R V I C E  
 E I S S Z D A D A N C P I A R U S Z P  
 L J J D Z C F A N A I R X U I W A N  
 B J J I C X H F A N I E R Y Z I M  
 A G O E E K X H T S I G X I N I  
 S O F E E K H T S I G X I N I  
 I D F F H B A E S I Q I B E N D G Y E  
 D A J J H B A E S I Q I B E N D G Y E  
 E C Q J B I S S I Q I B E N D G Y E  
 S F X N S S A U W R U T U L G

**ADA**

- Animal
- Assistance
- Canine
- Disabled
- Dog

**Friend**

- Helping
- Kids
- Service
- Sit
- Speak



A service dog is trained to do work or perform tasks for a person with a disability. This must be directly related to the individual's disability.

They can go in all places the public can go when they are working. They must have good public behavior and cannot be used to threaten people. They do not have to wear special tags or patches.

Fear of dogs and allergies are not valid reasons for preventing a service dog from accessing the space.

The user does not have to demonstrate the task or tasks the service dog was trained to do. Some examples of tasks are: opening doors, turning on lights, alerting to a diabetic high or low, alerting to sounds and much more. The most well known task is guiding a person who is blind. Service dogs are what some people with disabilities need to be independent. Emotional support and companionship are not qualified work or tasks for service dogs. For many with disabilities a service dog with skills to meet those needs is the perfect tool.

Service dogs can be male or female and can be pure breeds or mix breeds. The most common breeds used are golden retrievers and Labrador retrievers.



## Homemade Dog Toys

### The Rope Ball

Things you will need:

- Piece of rope 12 inches or more in length.
- 1 Tennis ball.

Steps:

- Cut a hole in the tennis ball just enough for the rope to go through.
- Slide the rope through the hole until the rope is even on both sides.
- After the rope is through the ball tie a knot on each side.

### The Ball Sock

Things you will need:

- 2 Long Socks.
- 2 tennis Balls.

Steps:

- Place one ball in each sock.
- After the balls are placed in socks tie the socks together.

Draw a picture of what you think a service dog does.

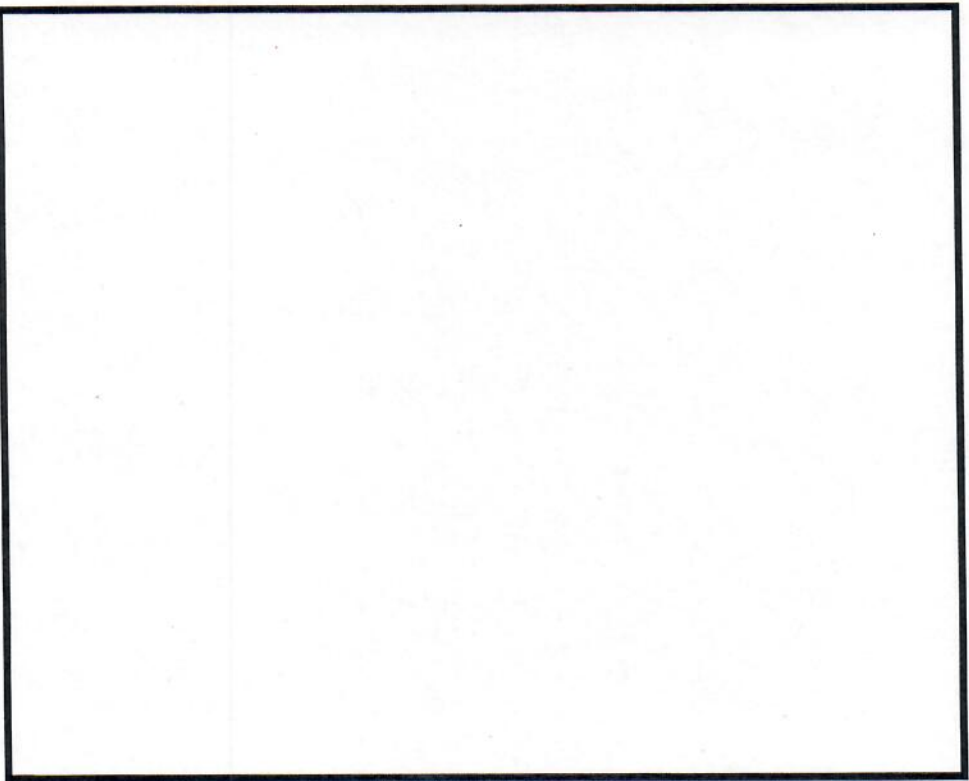

## Fun Facts About Service Dogs

- Dogs are in training for approximately 2 years before they become service dogs
- It costs an average of \$25,000 to train a service dog.
- Do not touch or talk to a service dog without permission because you may prevent them from doing their job. This could get the dog in trouble and their partner be put at risk
- There are only two questions that all service dog users must answer.
  1. Is that a service dog?
  2. What work or task has the dog been trained to perform?
- Service dogs go to the bathroom on command. They do this to fit their owners' schedules and so that owners can easily clean it up.
- Canines for Disabled Kids awarded over 250 scholarships between 1998–2015
- In 2013 an anesthesiologist requested his patient's medical alert service dog attend her surgery to give them advanced warning of her anaphylaxis reactions

**In the space below design your own wheelchair. There are no limits to what you can put in your own wheelchair.**

**Be as creative as you want.**

**Think of a sport you like to play. How would you modify it so a person with a disability could play with you?**

**Think about equipment, rules, the location and other possible changes**



Below is your house. Imagine you are in a wheelchair. How would you make this house more accessible for you? Draw the changes you would make on the outside of the house and describe the changes you can make on the inside of the house on the lines below.

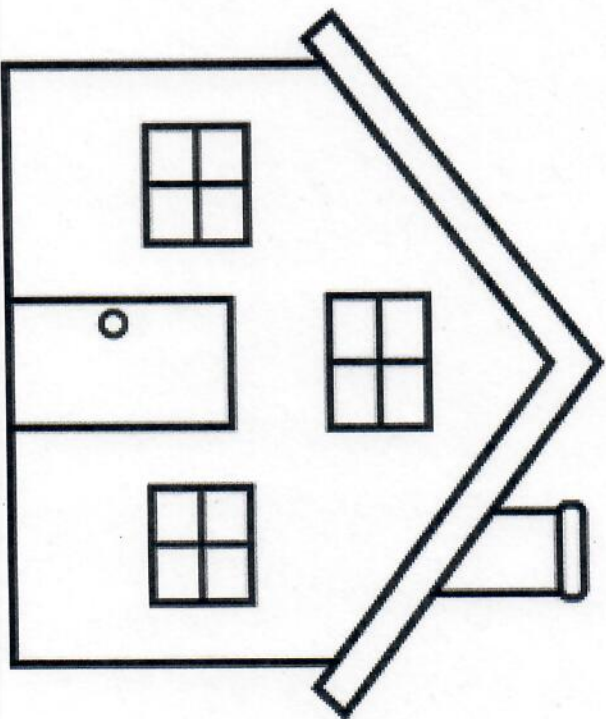

---

---

---

---

---

---

---

---

What two questions can we ask someone with a service dog?

1. \_\_\_\_\_  
\_\_\_\_\_

2. \_\_\_\_\_  
\_\_\_\_\_

Do you touch or talk to a service dog without permission? Why? How do you request permission?

\_\_\_\_\_  
\_\_\_\_\_  
\_\_\_\_\_

Do you know anyone who would benefit from a service dog?

\_\_\_\_\_  
\_\_\_\_\_  
\_\_\_\_\_

How many scholarships has “Canines for Disabled Kids” sponsored since 1998?

\_\_\_\_\_

When they are working, where can service dogs go?

\_\_\_\_\_

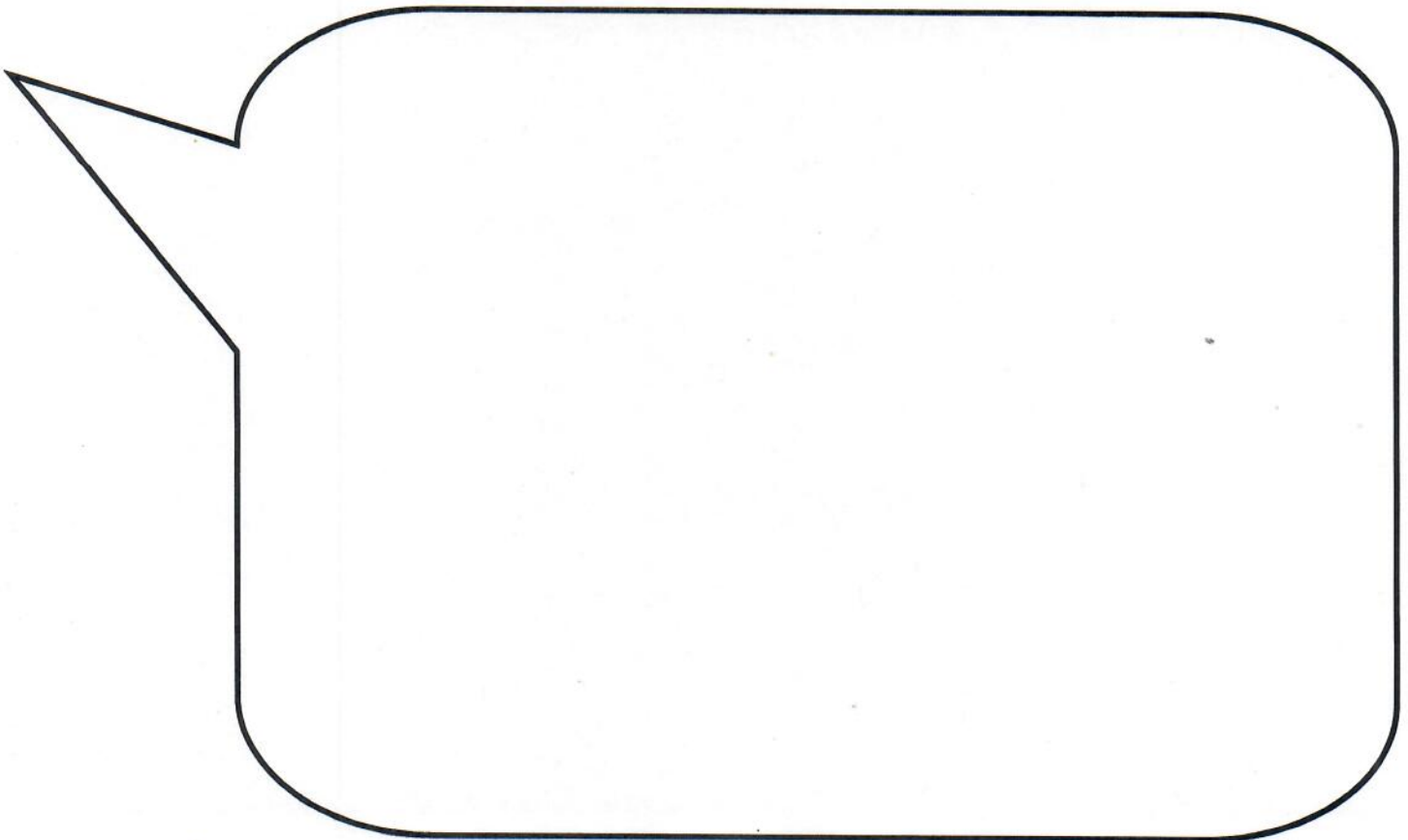

# Contact Information

## Phone

978-422-5299  
888 Kid Dogs

## E-mail

[info@caninesforkids.org](mailto:info@caninesforkids.org)

## Website

[www.caninesforkids.org](http://www.caninesforkids.org)

## Facebook

[www.facebook.com/Caninesforkids](http://www.facebook.com/Caninesforkids)

## Twitter

[@k94kids](https://twitter.com/@k94kids)

## Instagram

[@Caninesfordisablekids](https://www.instagram.com/Caninesfordisablekids)

## Mail

65 James Street, Suite 210  
Worcester, MA 01603

